

PRAISES *Continued*

**A Campaign for
Great Plains Lutheran High School
Watertown, South Dakota**

United in Praise – Plans Accomplished!

After many years of dreaming, evaluating, praying and planning, in November 2019 the Great Plains Lutheran High School Association delegates approved a revised Master Site Plan and Facility Expansion Plan. These plans included:

- a fine arts addition including space for worship, music instruction, lessons, rehearsals, concerts, performances, and fine arts storage
- a classroom addition to provide the classrooms we need now and into the foreseeable future
- a classroom remodel to create needed additional administrative offices
- an auxiliary gym to relieve scheduling tension and provide new utilization opportunities
- a link to the auxiliary gym containing a new kitchen and dining area

By the grace of God and with the support of his people, we were blessed to unite in praising God through the construction of the new kitchen and dining area (completed winter 2022), as well as the worship, performing arts and music addition (spring 2022), along with the auxiliary gym (fall 2022).

United in Praise – Blessings Realized!

It is exciting to see several years of dreaming and planning become a reality! We are blessed to be making use of all three new areas of our building.

- The music area is filled with the sights and sounds of music classes, band and choir rehearsals, individual and group practices, piano and organ lessons, and more.
- The chapel-auditorium is doing an excellent job of supporting our worship opportunities – from daily chapel services to special services, like district convention worship and our opening service of the school year. The spoken word is clearly heard. Played and sung music comes through clearly. Video displays are easily seen. Technology makes for quality streaming. Assemblies, concerts, and theater performances – as well as all who attend them – benefit greatly from this new space.
- Our new kitchen is functioning well, and the new cafeteria is a welcome home not only to daily lunchtime, but also other functions and gatherings and fellowship time. As we use the auxiliary gym for classes, practices, and activities, we are eager to see how many additional ways this new space will be used, including use by community groups that gives us the opportunity to show and tell more and more people about the blessings of a Christ-centered education at Great Plains Lutheran High School.

**United
in PRAISE**

Thank you for making these new facilities a reality! If you are in the area, stop in. Take in an activity. Or plan a trip to GPL. We'd love to show and tell you how God is blessing our ministry and students!

Our Mission:

**Great Plains Lutheran High School provides a Christ-centered education
to assist families in nurturing students as lifelong disciples of Christ**

Praises Continued!

It is indeed a blessing to be using our new facilities. However, there is more work to be done. These newly-constructed spaces represent 3 of the 5 areas targeted for expansion. What remains is a classroom addition which makes possible additional office and meeting space.

Challenge: Our classroom, meeting, and office spaces are not adequate for our current and future staff and student needs

Solution: Construct a four-classroom addition
Repurpose an existing classroom for administrative staff
Gain space for student counseling and small group meetings

You can help make this solution a reality.

Here is the proposed floor plan:

The important thing is that... Christ is preached. And because of this I rejoice. Yes, and I will continue to rejoice.

Philippians 1:18 (NIV)

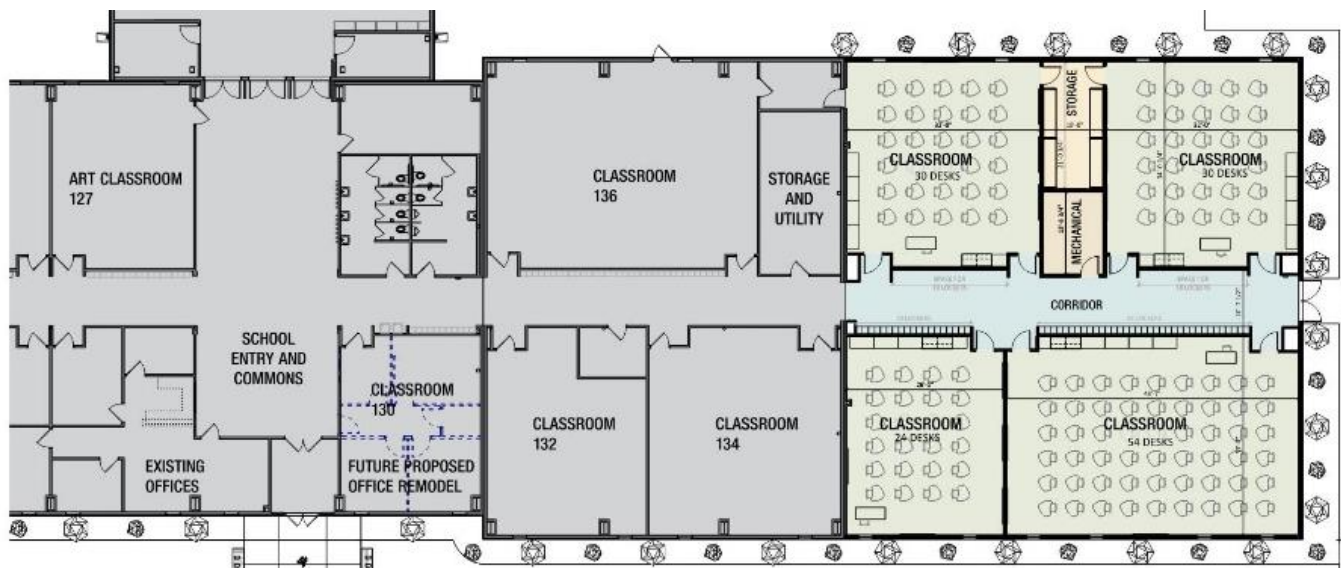

CLASSROOM ADDITION OPTION 1

10/11/2023 JLG 19250 ©2023 JLG ARCHITECTS

We invite you to offer a gift in support of Praises Continued!

Your gift will help us continue to praise our God by providing the facilities that will enable Great Plains Lutheran High School to better serve students and the broader GPL community in pursuing excellence today and well into the future.

Through Jesus, therefore, let us continually offer to God a sacrifice of praise—the fruit of lips that openly profess his name.

Hebrews 13:15 (NIV)

We will have the classrooms to accommodate larger sections, study hall and testing, and our Learning Resource Center; classrooms will provide space for teacher preparation and needed additions to the curriculum.

We will have the administrative space to focus on tasks, meet with constituents, and make visitors feel welcome.

We will have the meeting and counseling space that will enable us to confidentially support students, families and others—educationally, spiritually, and emotionally.

We will have the ability to serve efficiently and effectively a student body of 160 and have space for anticipated growth.

Praises Continued! – Financial Goal

The estimated total cost of the project is \$1.8 million. Our goal is to raise this amount through one-time gifts and three-year pledges.

The chart below represents an example of the number and type of gifts necessary to gather \$1.8 million. It is intended to be a guideline for your use. It may seem like a challenging, even impossible goal. However, it may help you see your place in making this goal a reality.

Number and Gift Type	Total for Gift Type	Progress toward Goal
1 gift of \$500,000	\$500,000	\$500,000
2 gifts of \$300,000	\$600,000	\$1,100,000
3 gifts of \$100,000	\$300,000	\$1,400,000
3 gifts of \$50,000	\$150,000	\$1,550,000
3 gifts of \$30,000	\$90,000	\$1,640,000
4 gifts of \$10,000	\$40,000	\$1,680,000
10 gifts of \$5,000	\$50,000	\$1,730,000
10 gifts of \$3,600	\$36,000	\$1,766,000
20 gifts of \$1,800	\$36,000	\$1,802,000
20 gifts of \$1,000	\$20,000	\$1,822,000
20 gifts of \$400	\$8,000	\$1,830,000

Teach me your way,
LORD, that I may rely on
your faithfulness; give me
an undivided heart, that I
may fear your name. I
will praise you, Lord my
God, with all my heart; I
will glorify your name
forever.

Psalm 86:11-12 (NIV)

Praises Continued! – Our Vision for Future Development

Our vision to praise the Lord through our facilities and programs extends beyond the addition of classrooms and meeting space.

This is what we see on the horizon:

- Outdoor green space designed for academic use, while also being inviting and welcoming to the community
- A green house and campus development including the parking needed to support our programs and activities
- Outdoor activity space that remains usable after heavy rains
- A home football field, track and field where our students can continue to strive for excellence

Praises Continued! – Planning Your Gift

This chart serves as a guide as you prayerfully consider your level of support.

Total Gift	Initial Gift	Balance	Monthly	Quarterly	Semi-Annual	Annual
\$500,000	\$50,000	\$450,000	\$12,500	\$37,500	\$75,000	\$150,000
\$300,000	\$30,000	\$270,000	\$7,500	\$22,500	\$45,000	\$90,000
\$100,000	\$10,000	\$90,000	\$2,500	\$7,500	\$15,000	\$30,000
\$50,000	\$5,000	\$45,000	\$1,250	\$3,750	\$7,500	\$15,000
\$30,000	\$3,000	\$27,000	\$750	\$2,250	\$4,500	\$9,000
\$10,000	\$1,000	\$9,000	\$250	\$750	\$1,500	\$3,000
\$5,000	\$500	\$4,500	\$125	\$375	\$750	\$1,500
\$3,600	\$360	\$3,240	\$90	\$270	\$540	\$1,080
\$1,800	\$180	\$1,620	\$45	\$135	\$270	\$540
\$1,000	\$100	\$900	\$25	\$75	\$150	\$300
\$400	\$40	\$360	\$10	\$30	\$60	\$120

The incremental payment examples are based on an initial 10 percent investment followed by the preferred payment plan for three years.

Praises Continued! – Next Steps

How to Make a Gift to *Praises Continued!*

- 1) Consider the challenges and solutions. Take time to pray and reflect upon this opportunity. Thank God for the blessings given to Great Plains Lutheran High School.
- 2) Decide how you would like to support *Praises Continued!* We believe each gift given in faith will have a lasting impact on the students and programs of Great Plains Lutheran High School.
- 3) Plan your gift; determine the amount that will be given as an initial gift and, if desired, the amount that will be given over time.
- 4) Consider converting your monthly pledge gift to monthly Active Ministry support at the conclusion of your pledge period.
- 5) Submit your gift following the instructions on the *Praises Continued* Support Form.

[Link to *Praises Continued* Support Form](#)

For answers to your questions or guidance, please call the GPLHS Office at 605-886-0672.

Thank you for supporting our ministry and students!

PRAISES *Continued*

Campaign Prayer:

O LORD, you have taught us your way, that we may rely on your faithfulness. In Christ you have given us undivided hearts, that we may fear your name. In grace you have united us in praising you through expanded facilities and programs at Great Plains Lutheran High School. For this we give you thanks.

We now ask that you enable us to continue this praise through our current facility expansion effort. Bless the planning and the gathering of resources that will make this plan a reality. Fill us with heartfelt generosity. Let us, our school, and these facilities be a sacrifice of praise through which we openly profess your name.

May we praise you, LORD, with all our hearts. May we glorify your name forever. Amen.